

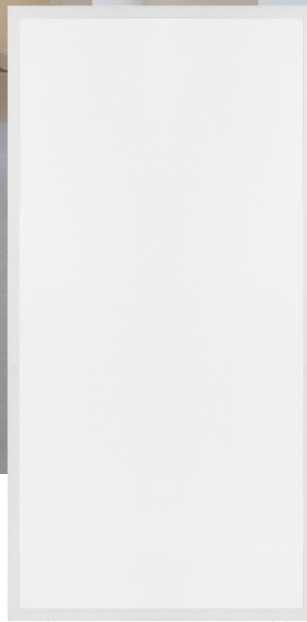

DEEP ROOF LIGHTING

5PC P

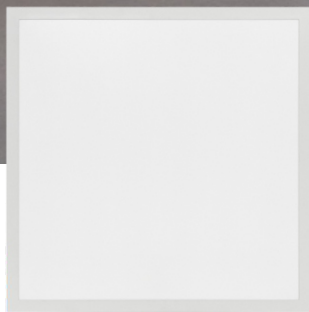

BACK-LIT LED PANEL LIGHT

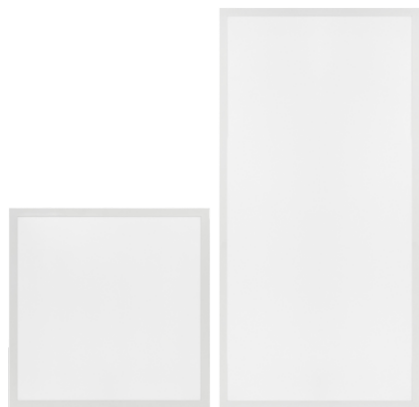

BACK-LIT LED PANEL LIGHT

Power&CCT Tunable

APPLICATIONS: Education, healthcare and office.



PRODUCT SPECIFICATIONS

- Delivering up to 130LPW
- CRI: Ra \geq 80
- CCT Tunable: 3000K / 3500K / 4000K / 5000K / 6500K
- 5 different power tunable
- Dimmable: 0-10V
- Smooth and comfortable light, no glare
- Estimated Lifetime @ 25 °C: > 54,000 hours
- Power Factor: > 0.95
- Total Harmonic Distortion: < 15% at full load
- Limited Warranty: 5 years
- Microwave induction and Bluetooth control are optional
- Operating Temperature Range: -22°F to 104°F (-30 °C to 40 °C)

ORDERING INFORMATION

Item Code DLC MODEL	SIZE	INPUT VOLTAGE	POWER (TUNABLE)	CCT (TUNABLE)	CRI	LUMINOUS EFFICIENCY	DIMMABLE	LIMITED WARRANTY
LP22-WP-G5PC-D1 BPL5-22-40W-L-H	2x2 FT	120-277VAC	20W/25W/30W/35W/40W	3000K 3500K 4000K 5000K 6500K	Ra > 80	130lm/W	0-10V	5 years
LP14-WP-G5PC-D1 BPL5-14-40W-L-H	1x4 FT		20W/25W/30W/35W/40W					
LP24-WP-G5PC-D1 BPL5-24-72W-L-H	2x4 FT		30W/40W/50W/60W/72W					

> high bay list

FIXTURE SPECIFICATIONS

HOUSING	White high-strength metal frame, seamlessly
LENS ASSEMBLY	PMMA Lens and polystyrene diffuser prevents hot spots, shadows and glare, while providing uniform illumination
MOUNTING	Recessed Installs into conventional grid ceilings
RECOMMENDED USE	Offices / Educational & Retail / Commercial & Institutional

PRODUCT DIMENSIONS

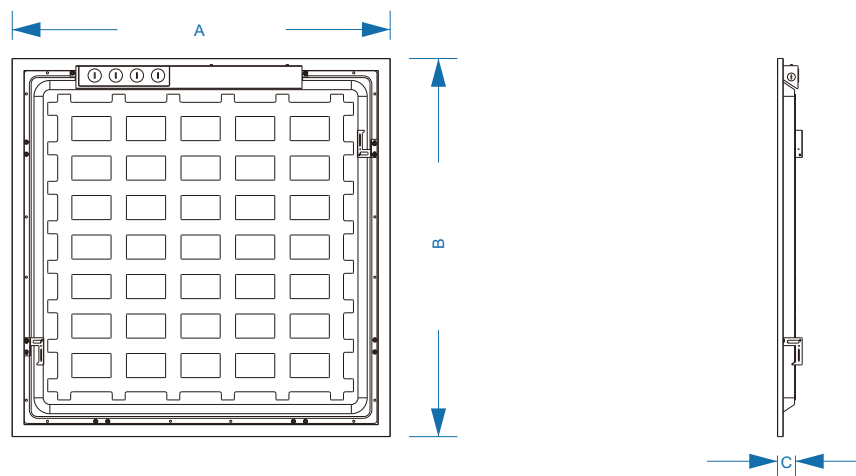

Item Code DLC MODEL	SIZE	A(inch)(mm)	B(inch)(mm)	C(inch)(mm)
LP22-WP-G5PC-D1 BPL5-22-40W-L-H	2x2 FT	23.74"(603mm)	23.74"(603mm)	1.38"(35mm)
LP14-WP-G5PC-D1 BPL5-14-40W-L-H	1x4 FT	47.75"(1213mm)	11.93"(303mm)	1.38"(35mm)
LP24-WP-G5PC-D1 BPL5-24-72W-L-H	2x4 FT	23.74"(603mm)	47.75"(1213mm)	1.38"(35mm)

LUMINAIRE AND ELECTRICAL PERFORMANCE

OPERATING TEMPERATURE RANGE	ESTIMATED LIFETIME @ 25°C (77°F)	POWER FACTOR	TOTAL HARMONIC DISTORTION	DIMMABLE
-22°F to 104°F (-30°C to 40°C)	54,000 hours	> 0.95 at full load	< 15% at full load	0-10V Dimming

POWER&CCT TUNABLE

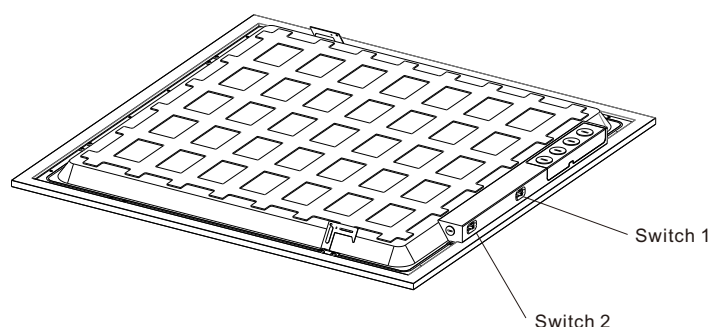

POWER TUNABLE(SWITCH1)

2x2FT / 1x4FT

20W 25W 30W 35W 40W

POWER TUNABLE(SWITCH1)

2x4FT

30W 40W 50W 60W 72W

CCT TUNABLE(SWITCH2)

2x2FT / 1x4FT / 2x4FT

3000K 3500K 4000K 5000K 6500K

LUMINOUS INTENSITY DISTRIBUTION DIAGRAM(2x2FT)

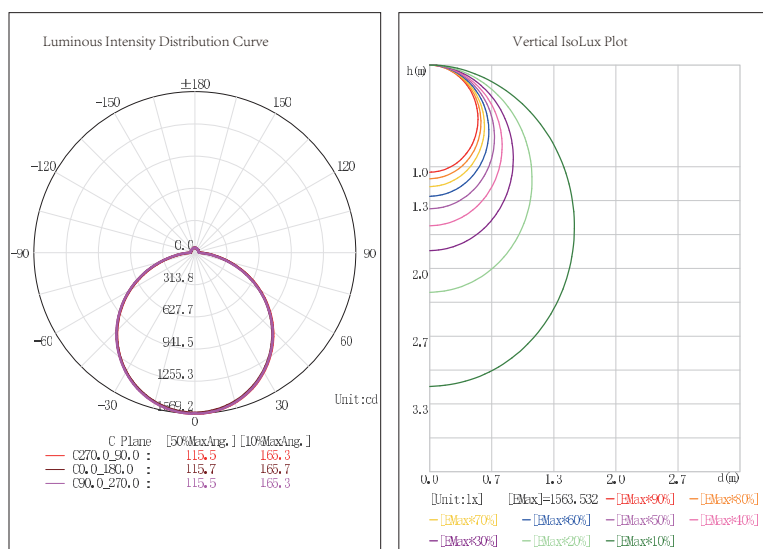

LUMINOUS INTENSITY DISTRIBUTION DIAGRAM(1x4FT)

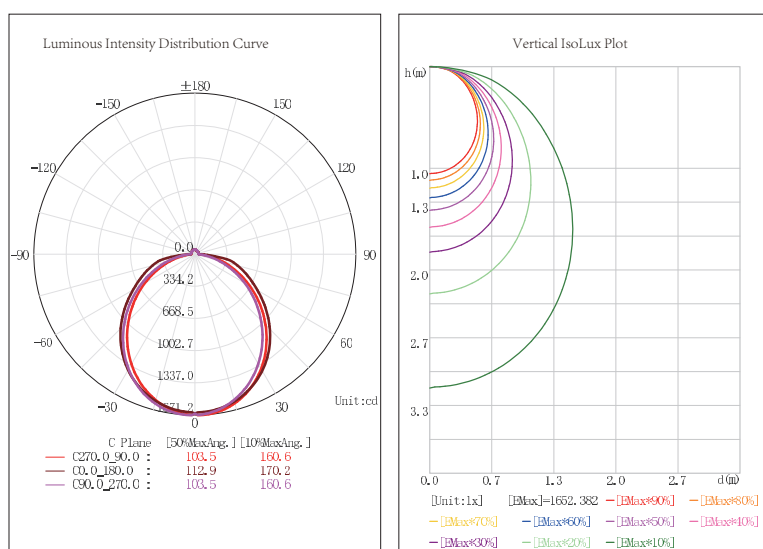

LUMINOUS INTENSITY DISTRIBUTION DIAGRAM(2x4FT)

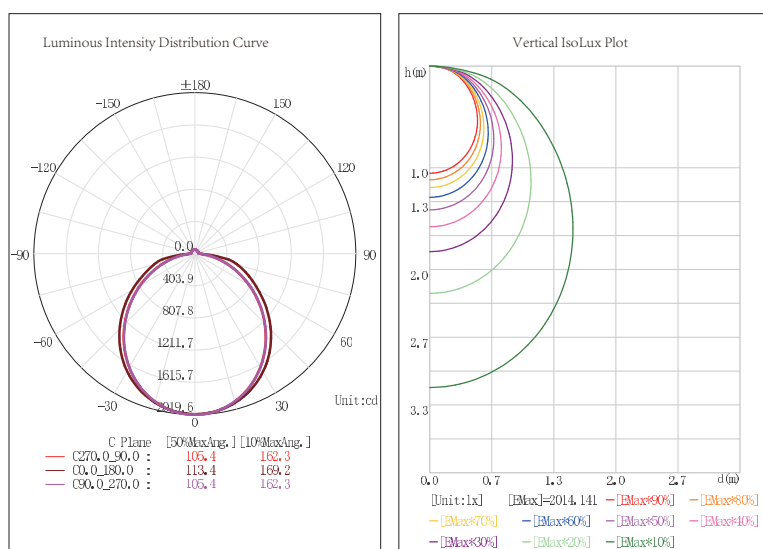

ACCESSORIES (OPTIONAL)

	MICROWAVE MOTION SENSOR PLUG & PLAY Model: HD08VR-MA-1 INFRARED REMOTE CONTROL Model: HD05R
	MICROWAVE MOTION SENSOR PLUG & PLAY Model: HD08VR-MB-1 (APP CONTROL)

MICROWAVE MOTION SENSOR PARAMETERS

FREQUENCY	5.8GHz±75MHz
MICROWAVE POWER	<0.3mW
INSTALLATION HEIGHT	6m/19.68ft Max
DETECTION DISTANCE	≥3m/9ft
DETECTION ANGLE	30-150°
DETECTION AREA	25% / 50% / 75% / 100%
HOLDTIME	<i>Remote control Options: 5s/ 30s/ 1min/ 3min/ 5min/ 10min/ 20min/ 30min</i> <i>APP Control Options: 5s/ 30s/ 1min/ 2min/ 3min/ 5min/ 10min/ 15min/ 20min/25min/ 30min/ 45min/ 60min/ 90min/ 120min</i>
DAYLIGHT THRESHOLD	Disable/400Lux/350Lux/300Lux/250Lux/200Lux/120Lux/80Lux/50Lux/30Lux/10Lux/2Lux
STANDBY DIMMING LEVEL	10% / 20% / 30% / 50%
STANDBY PERIOD	<i>Remote control Options: 0s/ 10s/ 30s/ 1min/ 5min/ 10min/ 30min/ 60min/+</i> <i>APP Control Options: 0s/5s/30s/1min/2min/3min/5min/10min/15min/20min/25min/ 30min/45min/60min/+ ∞</i>
DUSK/DAWN SENSING/PHOTOCELL	Daylight threshold as 30lux/50lux/80lux/120lux/200Lux/250Lux/300Lux/350Lux/400Lux
	Standby period as + ∞
	Standby dimming level as 10% / 20% / 30%
DUSK/DAWN SENSING/PHOTOCELL	1. Adjust "daylight" value higher than 50lux
	2. Preset "standby period" 0S
	3. press MW/PIR button 3 times till MW/PIR icons both blickingon LCD screen, daylight harvesting function enabled.(With BLE verison, press DH button, daylight harvesting function enabled.)
WIRELESS CONTROL RANGE	> 20m/65ft(bluetooth)
APP DOWNLOAD	Supported in both APP Store and Google play market
WORKING TEMPREATURE	-40°F~140°F(-40℃~60℃)
STORAGE TEMPREATURE	-40°F~176°F(-40℃~80℃) Humidity:85%(non-condensation)

MICROWAVE MOTION SENSOR DIMENSIONS

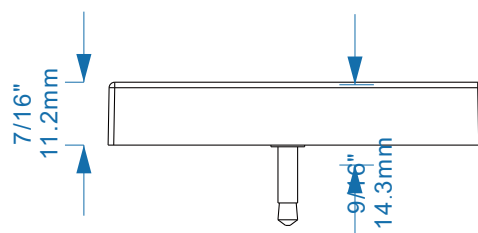
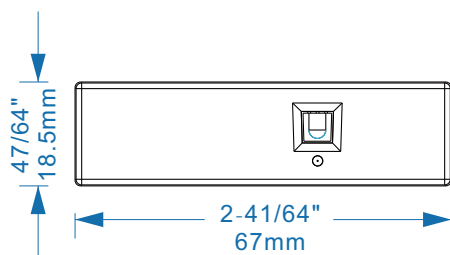

MICROWAVE MOTION SENSOR INSTALLATION

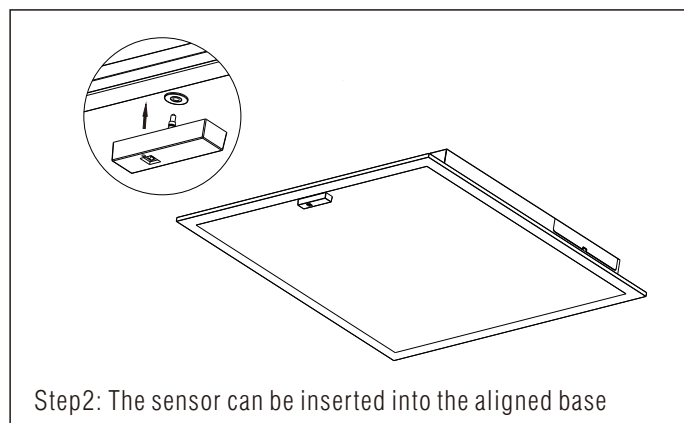
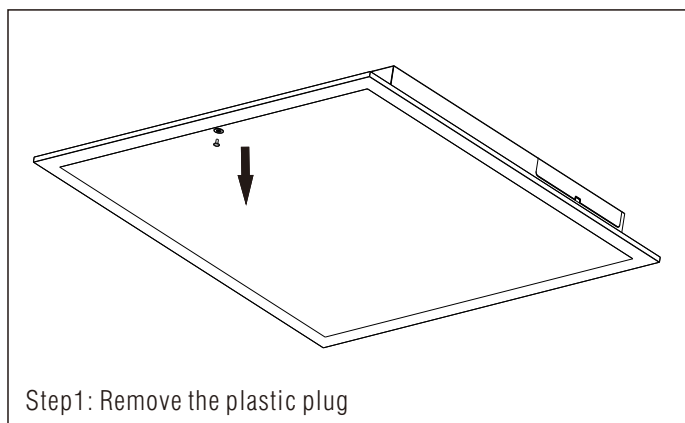

REMOTE CONTROL BUTTON FUNCTION INTRODUCTION

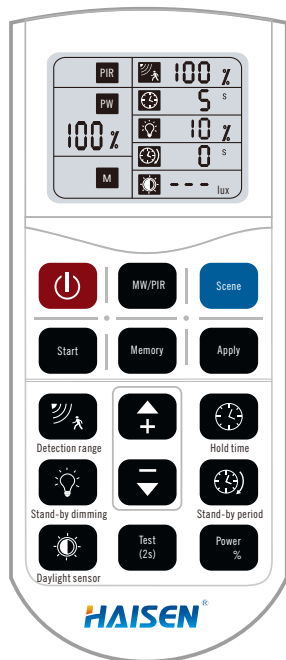

ON/OFF

Turn ON or OFF the sensor

NW/PIR

Exchange from Microwave detection to PIR detection, for future use

Reset

Press it to start detection programming; before pressing any other buttons, the screen shows default programming (Detection Area 100%, Holdtime 5S, Daylight Disable, Standby Dimming 10%, Standby Period 0S)

Start

Press it before you try to memorize program into the remote; After pressing it, S on the screen will blink and keeping blinking while making the program

Memory

Press it after programming, the blinking S will become a solid M, that means the program has been well memorized

Apply

Press it to deliver the preset program to the specific sensors; every press will make the whole screen blink gently

Detection area

Also known as "sensitivity", 100% means the highest sensitivity and longest distance. Press it, specific icon on the screen will blink and press the + - buttons to adjust

Hold time

The period that light will stay illuminated 100% after no motion is detected; Press it, specific icon on the screen will blink and press the + - buttons to adjust

Daylight Threshold

The preset lux level to compare with ambient brightness when motion gets detected; Press it, specific icon on the screen will blink and press the + - buttons to adjust

Stand-by period

The period after holdtime, during which the light keeps standby dimming level; Press it, specific icon on the screen will blink and press the + - buttons to adjust

Stand-by dimming level

After holdtime, the light will dim from 100% to optional standby dimming levels; Press it, specific icon on the screen will blink and press the + - buttons to adjust

UP

The main functional buttons to adjust the factors to wanted level

DOWN

POWER

Supports to manually change dimming output in detection mode; Press it, specific icon on the screen will blink and press the + - buttons to adjust

Test mode

Supports to check if the sensor works correctly with a short 2S holdtime; Press it and the holdtime will change to 2S, and it can't be memorized

APP OPERATION INSTRUCTION OF SMART SENSOR

APP DOWNLOAD

Our app HAISEN BLUE has been uploaded onto APP Store & Google Market



SIGN UP/LOG IN

Please select the region as US (because the server is located in the US.)
if you signing up with phone number; or with mail address without region restriction.

Log in if you already have account.

PROJECT MANAGEMENT

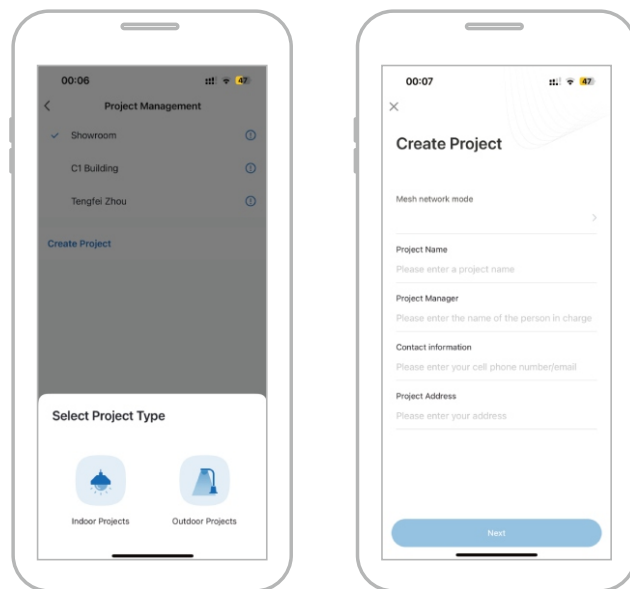

CREATE PROJECT

The app is specially designed for industrial project application, not only to control the SMART SENSORS but also HAISEN's Emergency Driver. It requires you to start a new project first before going on add or control devices.

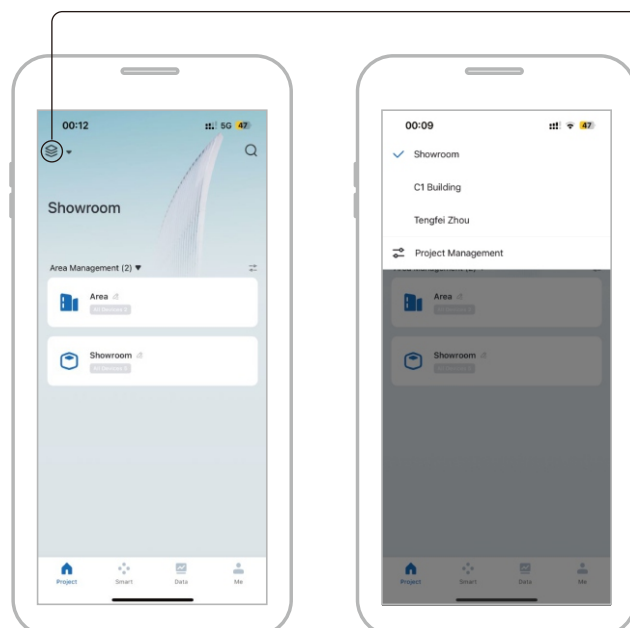

MANAGE PROJECT

Press the left top icon, all the projects will be shown, you can select or manage them.

APP OPERATION INSTRUCTION OF SMART SENSOR

ADDING

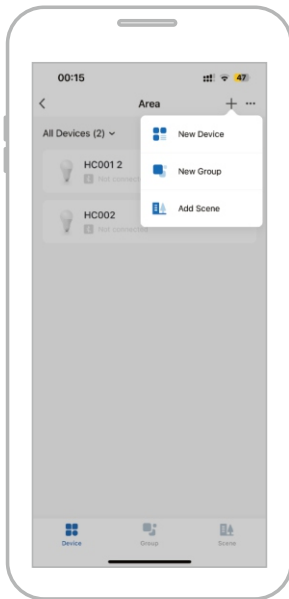

CREATE PROJECT

Adding New DeviceNew Group/Scenes.



ADDING NEW DEVICE

The app will automatically search the ready sensors in the connection area, list them and wait for your confirmation on adding.

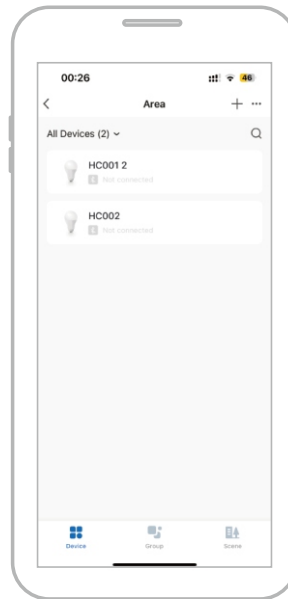

ADDING NEW GROUP

The app will show all the devices that can be added into a group.

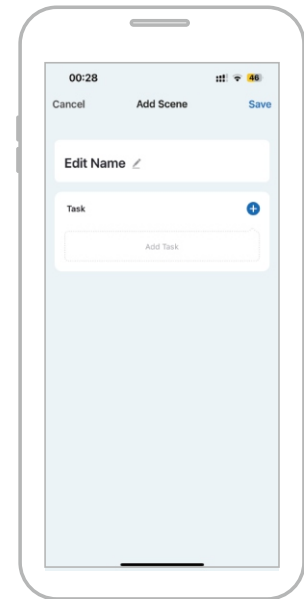

ADDING SCENES

The app will lead you to edit a scene with required task and save it as a new name.

CONTROL

Select the sensor or group to control it

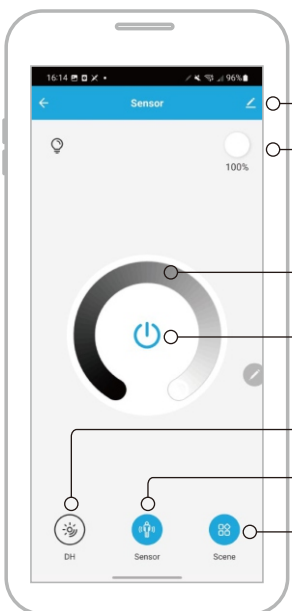

- Edit area, rename it or delete it
- Brightness Showing Part
- Brightness Changing
- ON/OFF Button
- Daylight Harvesting Button
- Sensor Setting Button
- Scene Setting Button

CONTROL PAGE -1

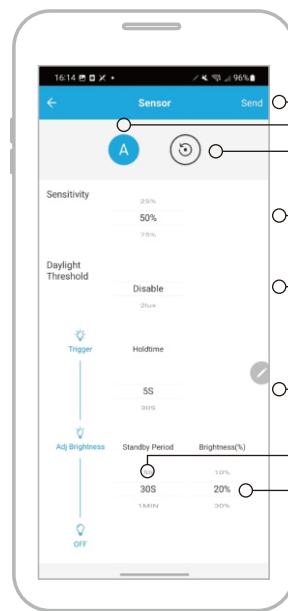

- Send after programming
- Auto mode
- Reset
- Sensitivity Setting
- Daylight Threshold Setting
- Holdtime Setting
- Standby Period Setting
- Standby Brightness Setting

CONTROL PAGE -2

APP OPERATION INSTRUCTION OF SMART SENSOR

HIGH-END TRIM

High-end Trimming is a very practical function for customers who prefer to have less than 100% brightness everytime the sensor detects motion, and our steps to approach it is very easy.

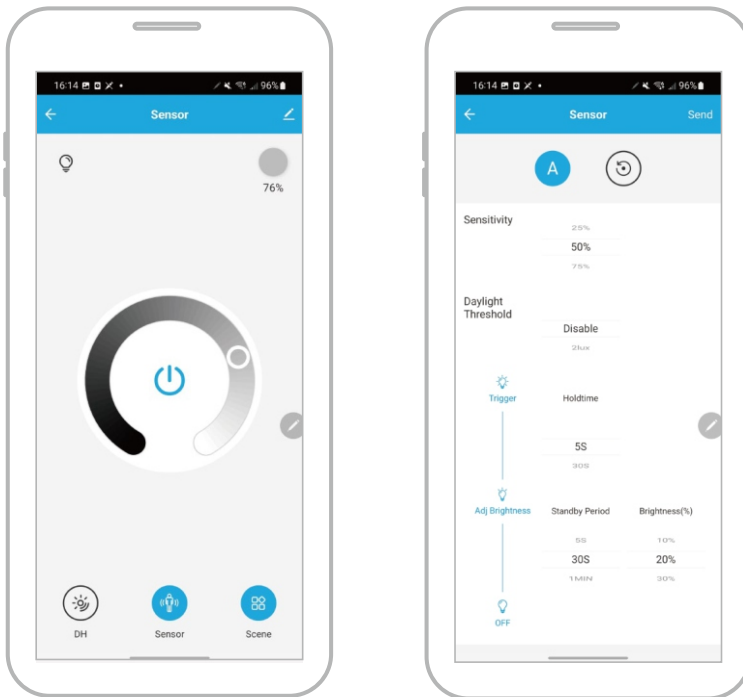

STEPS

- Dim the light to a level, for example 76%, simply by moving the block
- Press "sensor" at the bottom center and start making a program
- Then press "A" means running automation
- After setting, the sensor works as dimming to only 76% everytime it detects motion

DAYLIGHT HARVESTING

Daylight Harvesting function offers the possibility to dim the light brightness along with the change of natural brightness; when outside gets darker, indoor environment should become brighter.

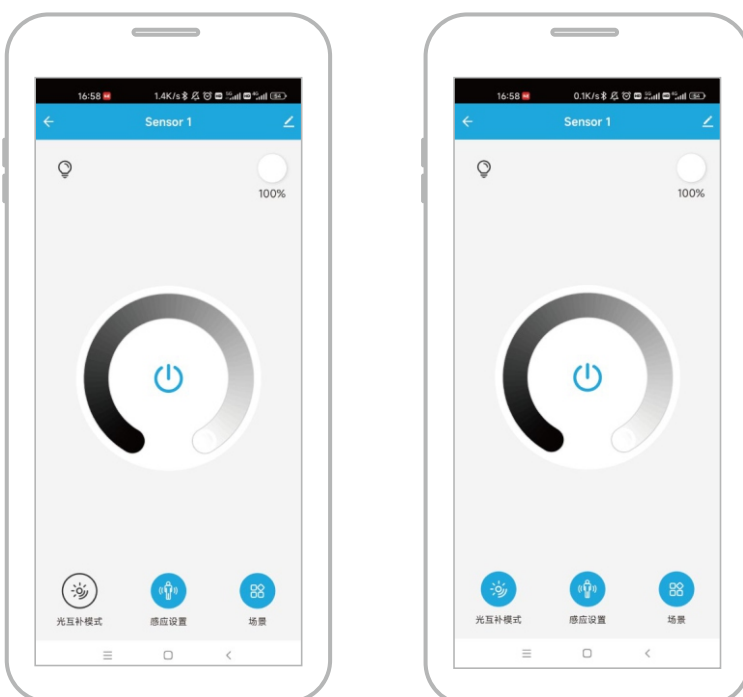

STEPS

- Press "sensor" at the bottom center and start making a program, daylight must be chosen higher than 50lux, meanwhile the standby period should be 0S
- After setting, the sensor works as dimming to only 76% everytime it detects motion

APP OPERATION INSTRUCTION OF SMART SENSOR

SMART

This app allows customer to make different schedules, set necessary working conditions and work it automatically.

Please follow below steps.

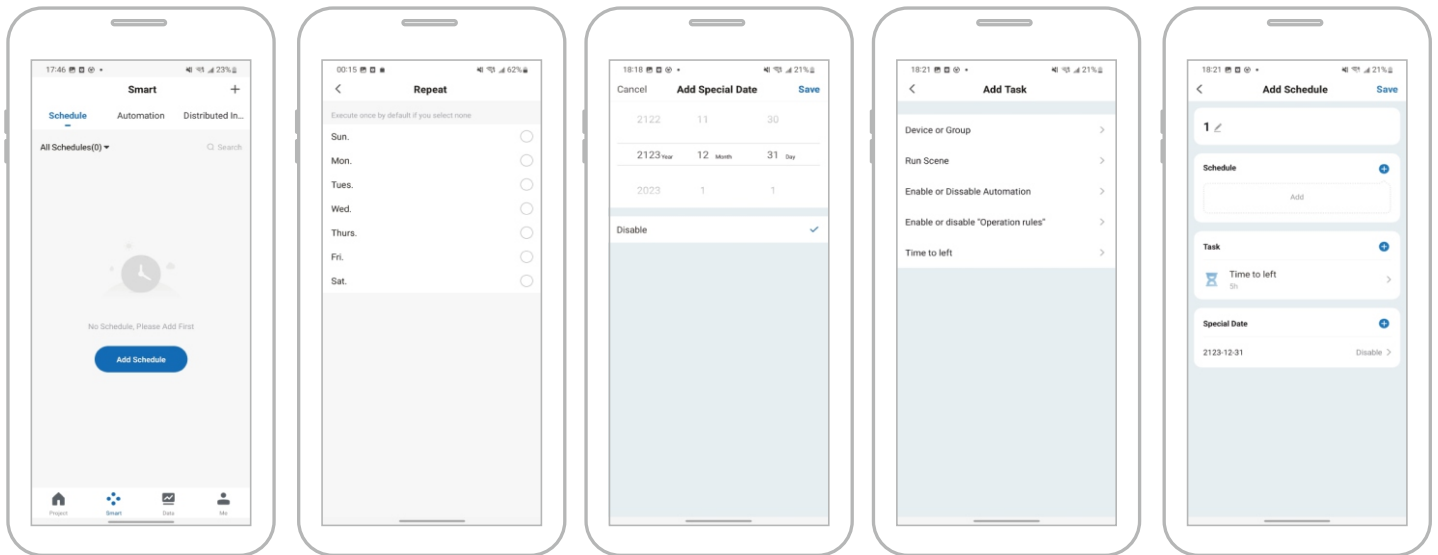

ENERGY MONITORING

This app supports to monitor energy consumption and automatically generates data in "DATA" area.

Please follow below steps.

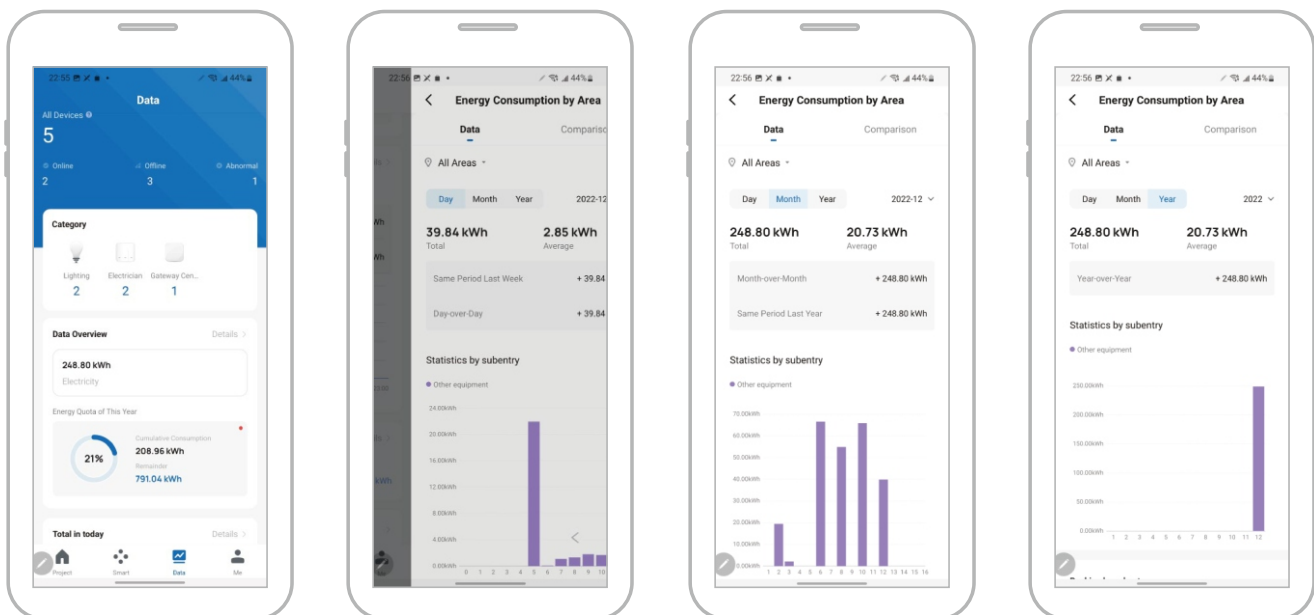

INSTALLATION INSTRUCTIONS



CAUTIONS

IMPORTANT SAFEGUARDS

When working with electrical equipment, basic safety precautions should always be followed, including the following:

READ AND FOLLOW ALL SAFETY INSTRUCTIONS

1. DANGER- Risk of shock- Disconnect power before installation.
2. This luminaire must be installed by the NEC or your local electrical code.
If you are not familiar with these codes and requirements, please consult a qualified electrician.
3. Suitable for conventional grid ceilings.
4. Make certain power is OFF before starting installation or attempting any maintenance.
5. Do not touch the LEDs or wires coming from the circuit board during the installation process. Damage may occur.

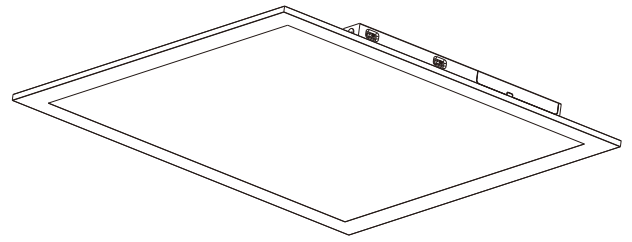

Installation Procedure

Step1: Remove 2x2 or 2x4 or 1x4 the from ceiling

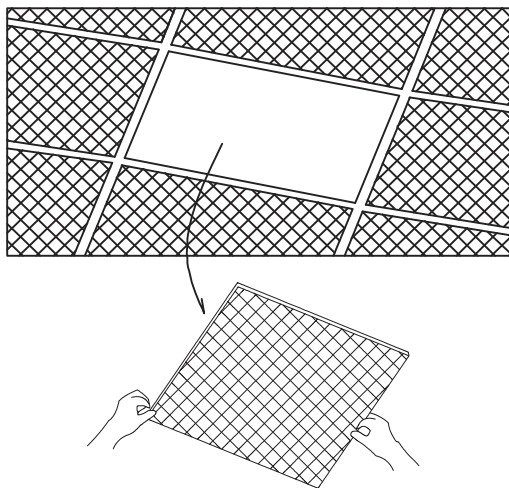

Step2: Place fixture into ceiling grid

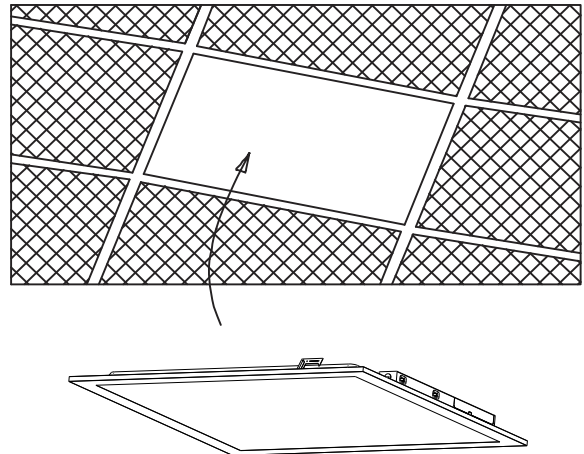

Step3: Follow the luminaire wiring diagram to wire the appliance correctly

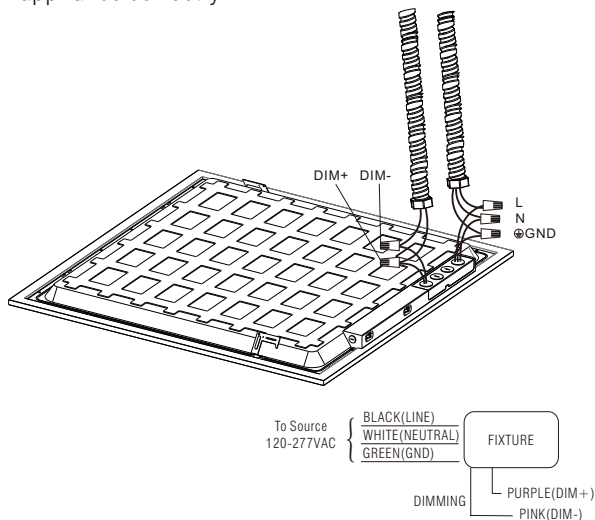

Step4: Pull the switch to the appropriate gear, Fixed wire hose on the panel, Then installation is completed

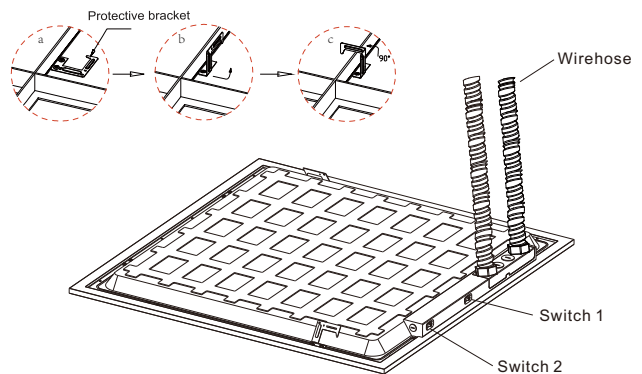

Watt Tunable: Switch 1
5 different power:
2*2FT: 20W-25W-30W-35W-40W
1*4FT: 20W-25W-30W-35W-40W
2*4FT: 30W-40W-50W-60W-72W

CCT Tunable: Switch 2
3000K-3500K-4000K-5000K-6500K

PACKAGING INFORMATION

PACKAGING/WEIGHT

PART NO.	SIZE	OUTER CARTON SIZE (L*W*H)	QTY/CARTON (PCS)	NET WEIGHT (KG)(LBS)	GROSS WEIGHT (KG)(LBS)	20GP (PCS)	40HQ (PCS)
BPL5-22-40W-L-H	2x2FT	613*170*625mm 24.13"*6.7"*24.6"	4 pcs	1.8kg 3.96lbs	9.5kg 20.9lbs	1648	3920
BPL5-14-40W-L-H	1x4FT	1223*170*325mm 48.15"*6.7"*12.79"	4 pcs	2.0kg 4.4lbs	9.5kg 20.9lbs	1680	3904
BPL5-24-72W-L-H	2x4FT	1223*170*625mm 48.15"*6.7"*24.6"	4 pcs	4.0kg 8.8lbs	17.8kg 39.16lbs	864	2036

PACKAGING

