



Construction

- 27-gauge metal sheet housing with powder coated finish
- Housing is absent of holes to resist debris/bug intrusion

LED CHARACTERISTICS

- LED's 5CCT Adjustable:
3000K/3500K/4000K/5000K/6500K, CRI>80.
- Lifespan 60,000-hour LED lifespan based on IES LM-80 results and TM-21 calculations

OPTICS

- Acrylic Lenses Over LEDs, Polystyrene Diffuser Lens
- UL 94-V0 flame retardant grade

Mounting and installation

- Recessed in T-bar grid ceiling with integral earthquake clips for secure attachment
- Surface mount and suspension mount cable kit accessories available

Compliance

- UL Listed
- TM-21 Projected L70 life >50,000 hours
- LM-79, LM-80 testing performed in accordance with IESNA standards.
- DesignLights Consortium® Qualified and classified for DLC Premium

Electrical

- 3 Powers / 5 Powers Selectable Option
- Power Factor: > 0.9 nominal
- Input Power: Stays constant over life
- Input Voltage: 120-277V, 120-347V, 50/60Hz
- Operating Temperature Range: -4°F ~ 104°F
- Total Harmonic Distortion: <20%

Emergency Battery

- Optional 120-277V/347V Integral Emergency Battery pack available in 8W or 15W
- 90-minute backup period for code compliance

Integrated Controls

- Dimming: 0%-100% (Varies by controller)

Warranty

- Five-year Limited Warranty.

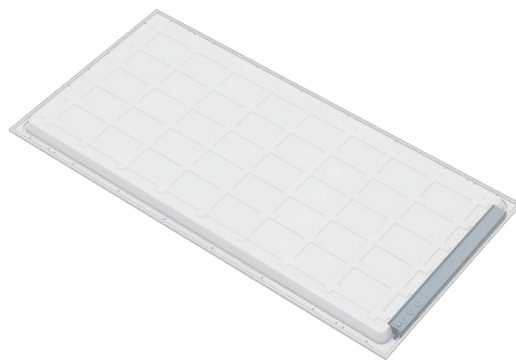

Order Information

Size	Part No.	Power	Input Voltage	Luminous Efficacy	Luminous Flux	CCT
1x4	Item LP14-WP-5P5C-P1P-3 DLC low bay list EDI-PAN14-15T50W-xx G3	no sensor base 15W-20W-30W-40W-50W 5 Powers Adjustable	120-277V	130lm/W	6500lm	3000K-3500K- 4000K-5000K-6500K Adjustable
2x2	Item LP22-WP-5P5C-P1P-3 DLC low bay list EDI-PAN22-15T50W-xxK G3	no sensor base 15W-20W-30W-40W-50W 5 Powers Adjustable	120-277V	130lm/W	6500lm	3000K-3500K- 4000K-5000K-6500K Adjustable
2x4	Item LP24-WP-5P5CB-P1P-3 DLC high bay list EDI-PAN24-20T72W-xxK G3	no sensor base 20W-30W-40W-50W-72W 5 Powers Adjustable	120-277V	130lm/W	10000lm	3000K-3500K- 4000K-5000K-6500K Adjustable

Dimension

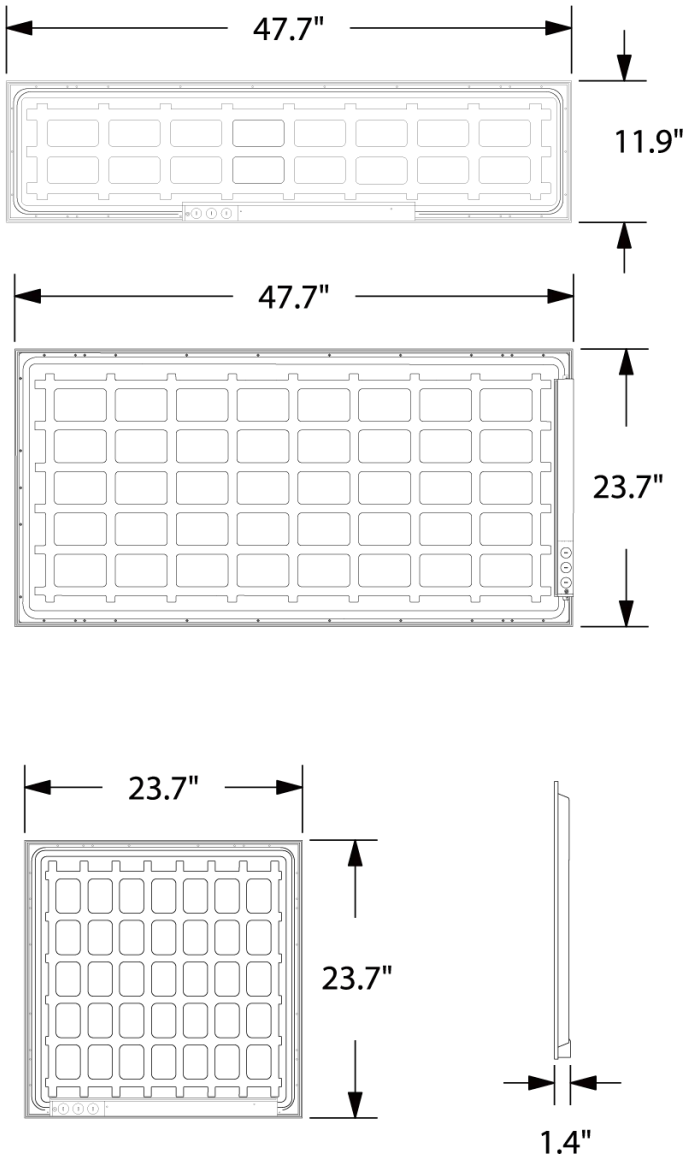

Installation Instruction

1

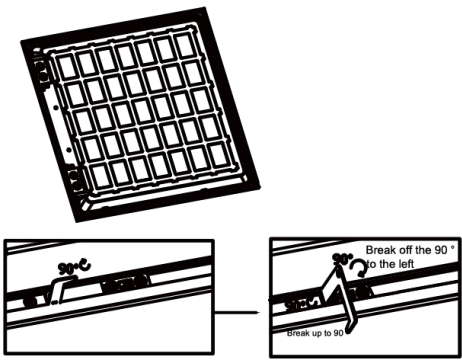

1.Remove the original ceiling tile for the backlit LED panel.

2

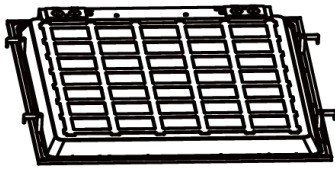

2.Turn off the electrical power then connect with L/N/GND wire leads.

3

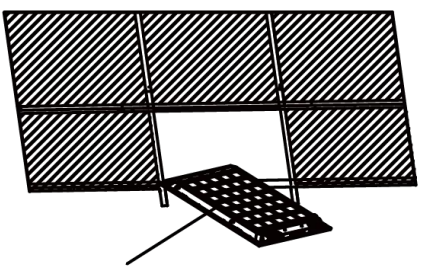

LED Panel light

3.Use the protective brackets for safety.

4

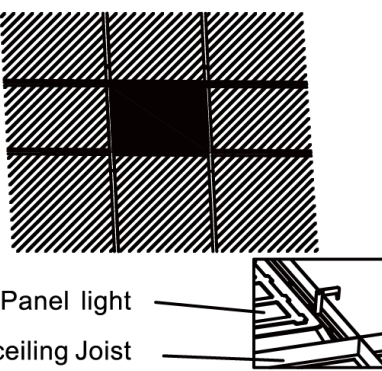

LED Panel light
ceiling Joist

4.Adjusted appropriate location in the T bar.

Packing / weight

Size	Outer box (L*W*H)	Qty/Ctn (pcs)	G.W/Ctn (lbs)	Container 20GP(pcs)	Container 40HQ(pcs)	Container 45HQ(pcs)
1x4'	50" x 7.5" x 14.2"	4	28.00	1436	3488	4000
2x2'	26" x 7.5" x 26"	4	26.10	1512	3674	4220
2x4'	50" x 7.5" x 26"	4	44.30	776	1888	2168

Warranty

This product has a warranty of period of 5 years from the date of purchase. The warranty is invalid in the case of improper use, installation, tampering or removal of the Q.C. and/or date label, usage in improper working environment or installation not according to the current edition of the National Electric Code. Should this product fail during the warranty period it will be replaced free of charge, subject to correct installation and return of the faulty unit. Manufacturer does not accept responsibility for any installation costs associated with the replacement of this product. This warranty is in addition to the statutory rights in your country of purchase. Manufacturer reserves the right to alter specifications without prior notice.

Note

- 1.The installation and maintenance must be completed by electricians or professionals.
- 2.Please cut off the power before installation and maintenance.
3. The thermally insulating material is not allowed to cover the fixture.
4. Please keep away from the corrosive substance, and keep the fixture dry and clean.
- 5.Working temperature: -4°F~104°F, storage temperature: -22°F~140°F.